

A

B

C

D

E

F

Inner Closure    Injection    Polypropylene  
Outer Closure    Injection    Polypropylene

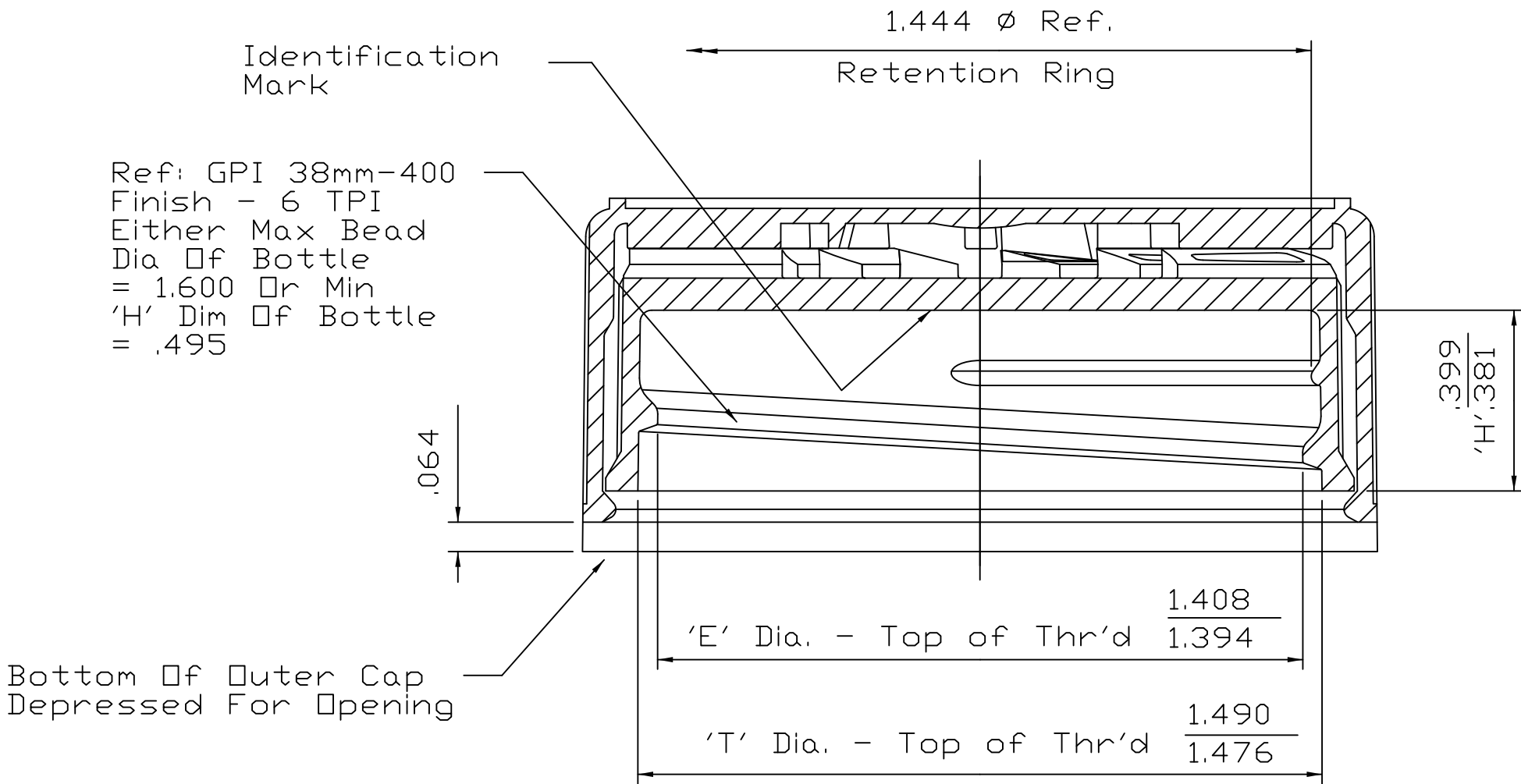
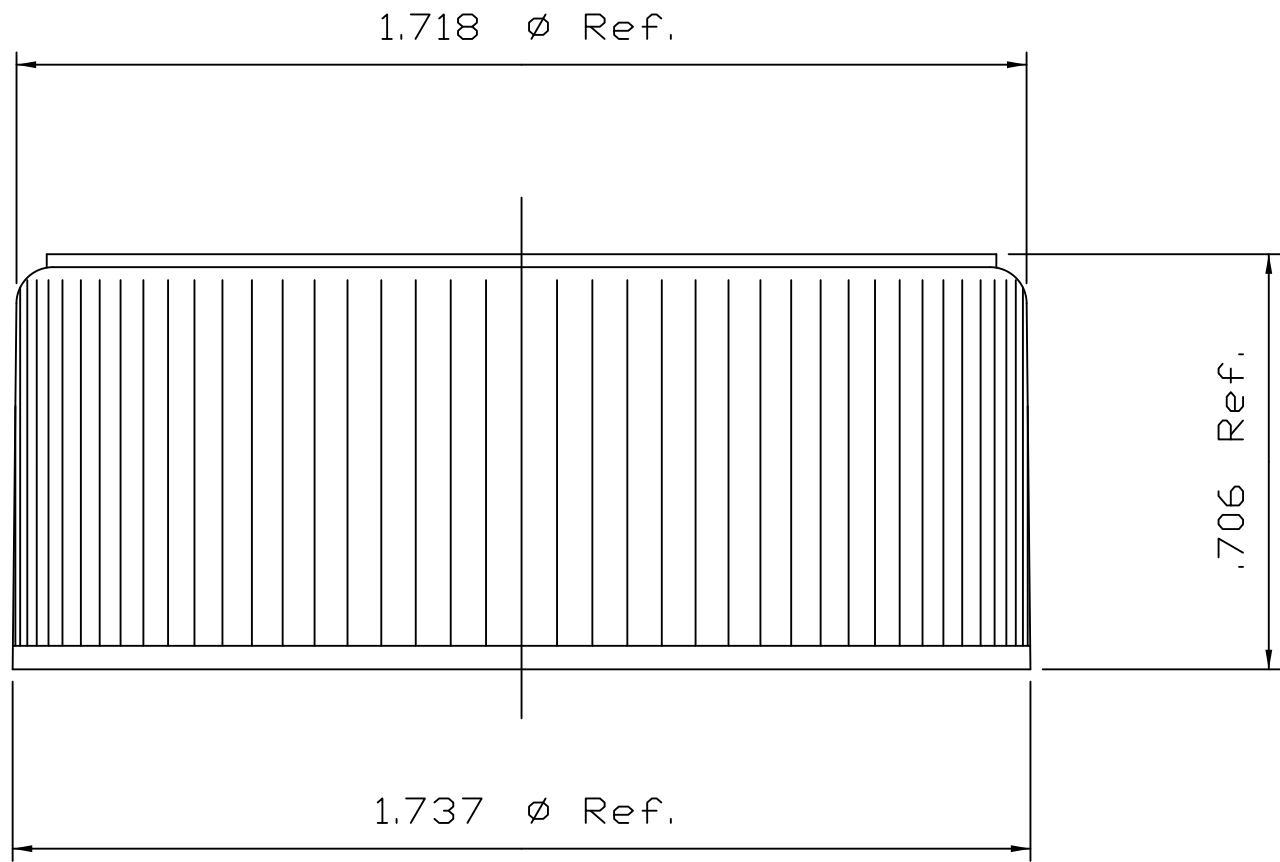
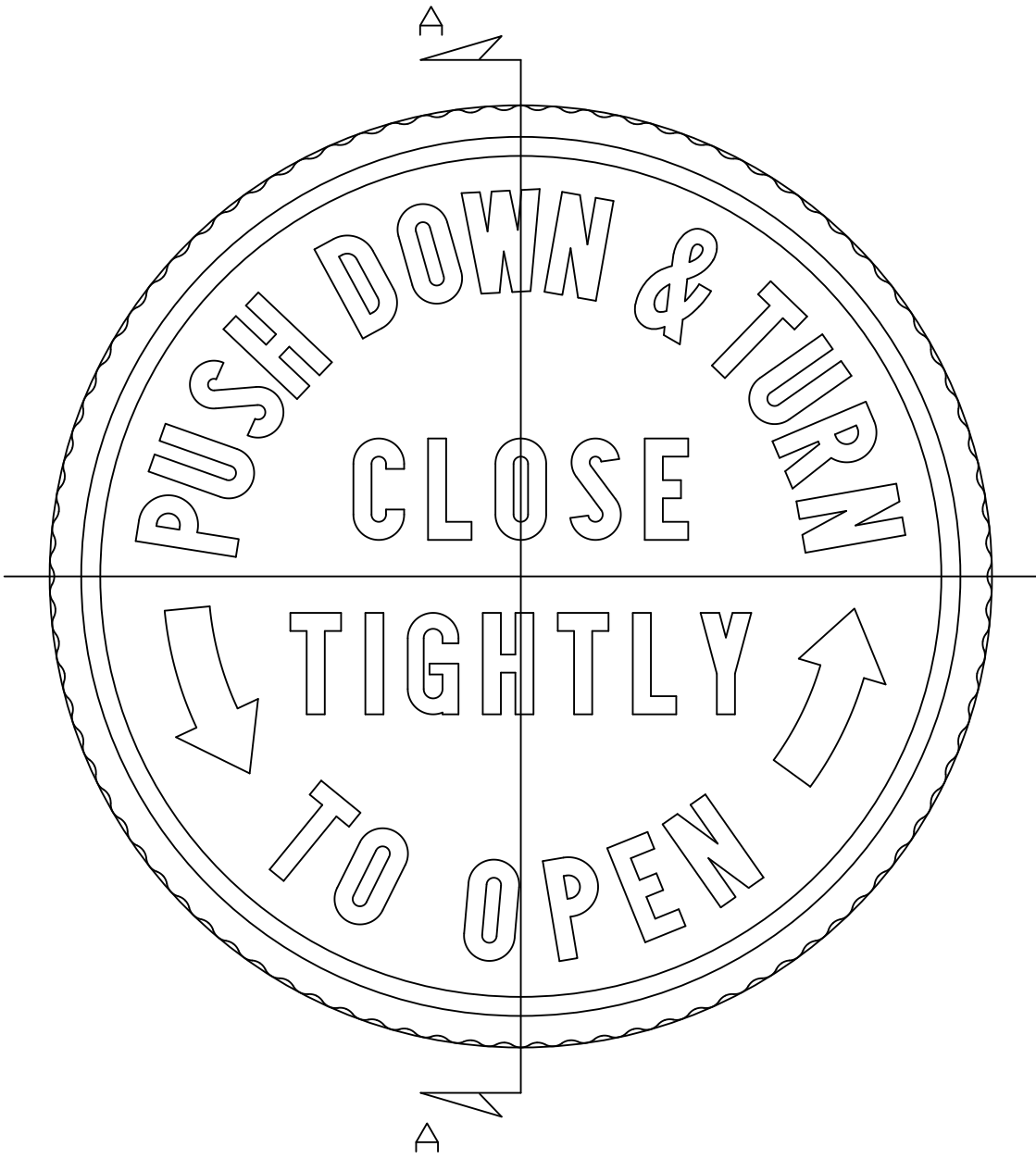

Identification Mark  
Ref: GPI 38mm-400  
Finish - 6 TPI  
Either Max Bead  
Dia of Bottle  
= 1.600 Or Min  
'H' Dim of Bottle  
= .495

Bottom of Outer Cap  
Depressed For Opening

SECTION A-A

REFERENCE DIMENSIONS ARE NOT INSPECTED AND NO TOLERANCE APPLIED		INSPECTION DIMENSIONS ARE VERIFIED WITH TOLERANCE			
THIS DRAWING IS NOT A CONTROLLED DOCUMENT IF PRINTED OR COPIED FROM THE APPROVED LOCATION					
 101 OAKLEY STREET EVANSVILLE, INDIANA 47706 TEL. (812) 424-2904	<b>CONFIDENTIAL</b> <small>THIS UNPUBLISHED WORK IS THE PROPERTY OF BERRY GLOBAL INC. AND IS PROTECTED BY TRADE SECRET, COPYRIGHT AND OTHER INTELLECTUAL PROPERTY LAWS AND MAY ALSO BE SUBJECT TO A SPECIFIC OR GENERAL CONFIDENTIALITY AGREEMENT. IT IS NOT TO BE VIEWED BY UNAUTHORIZED PERSONS OR DUPLICATED IN ANY MEDIUM FOR PURPOSES OTHER THAN THOSE FOR WHICH IT IS SPECIFICALLY FURNISHED.</small>				
	JDE TOOL NUMBER: <b>CR3840AFXC3</b>	DRAWING TYPE: <b>CUSTOMER</b>			
	DESCRIPTION: 38mm CR-III CLOSURE ASSEMBLY - 4596				
	DRAWING NO: CP-94232-C		PROJECT NUMBER:		
	CREATED BY: J.KOO	CREATION DATE: 02/04/09	DRAWING REVISION: C	SHEET 1 of 1	SCALE: 3:1