

CONFIDENTIAL

3D CAD IS THE MASTER MODEL FOR THIS PRODUCT

THIS DOCUMENT IS THE EXCLUSIVE PROPERTY OF AMCOR RIGID PLASTICS. THE INFORMATION CONTAINED HEREIN, AND ANY MODEL CONTAINER, PREFORM OR OTHER ARTICLE RECEIVED, IS OF A CONFIDENTIAL AND PROPRIETARY NATURE AND MUST BE USED ONLY FOR THE PURPOSE FOR WHICH IT IS DISCLOSED. THE HOLDER AGREES NOT TO DISCLOSE TO A THIRD PARTY AND TO RETURN THE SAME TO AMCOR RIGID PLASTICS UPON COMPLETION OF USE OR REQUEST. THIS DRAWING IS NO LONGER A CONTROLLED DOCUMENT WITHIN AMCOR RIGID PLASTICS. DO NOT ASSUME THAT THIS IS THE CURRENT DRAWING.

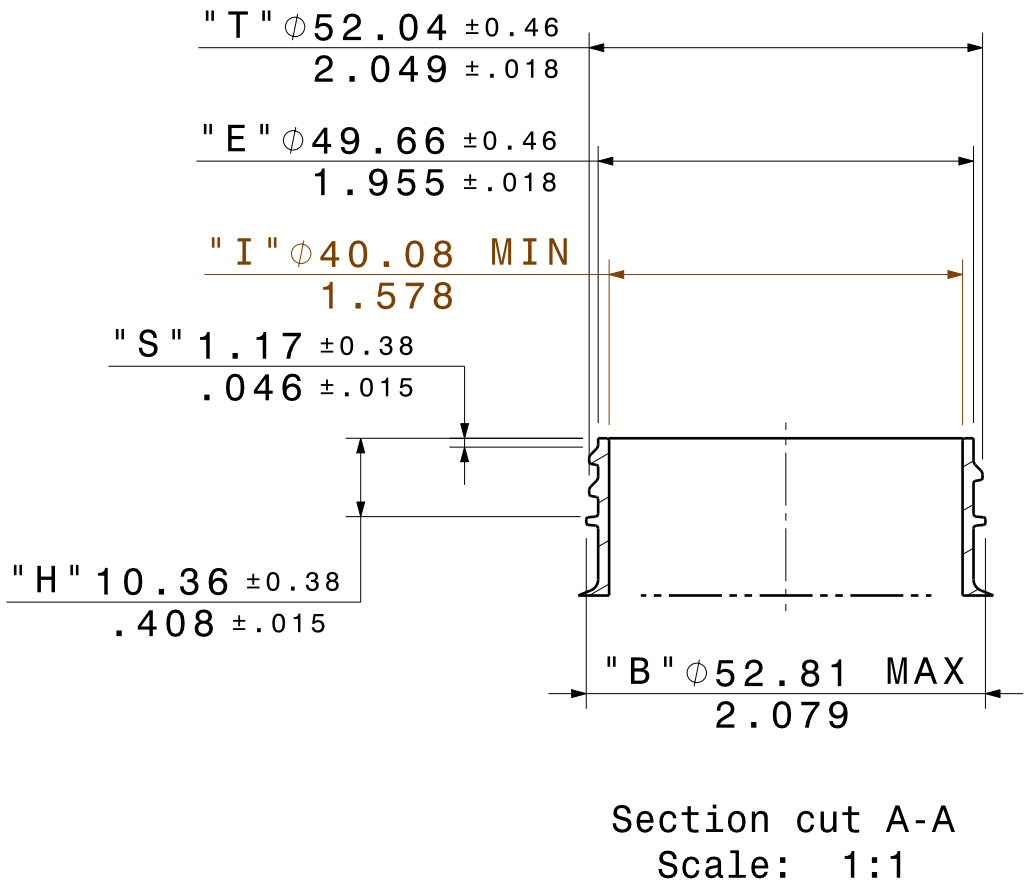

Isometric view
Scale: 1:1

Rev	Description	By	Date	ECR
A	Original Release	NDH	08JUN11	416410611230-002
B	UPDATED TITLE BLOCK NOTES, UPDATED OVERALL TOLERANCES, THREAD HEIGHT WAS 2.41, ADDED BEAD DETAIL, R.25 MAX WAS R.13 MAX, ADDED 1,3,5,6,7,& 8	NDH	19SEP11	416411511234-006
C	MODIFIED CUSTOMER TO "STOCK" (TITLE BLOCK)	JCG	21SEP11	416411311377-002
D	UPDATED DRAWING TO LATEST STANDARD UPDATED NOTES ADDED 5° DRAFT TO BEAD UPR & LWR SURFACES	NDH	12OCT11	416411511268-004
E	ADDED CONTAINER SIZE ENGRAVING	JMS	29FEB12	416411312027-005
F	ADDED CORPORATE LOGO ENGRAVING	JCG	29JUL13	416411512398-270

Notes:

1. Dimensions are nominal in millimeters/inches.
2. All dimensions not toleranced are for reference only.
3. This drawing represents the bottle 72 hours after manufacture when stored at normal conditions.
4. The dimensional tolerances to be applied to all height dimensions are the same as the tolerance applied to the Overall Height of the container.
5. The dimensional tolerances to be applied to all diameter, width and thickness dimensions are the same as the tolerance applied to the major diameter or width of the container.
6. Tolerances apply to the average of two measurements taken 90° apart on the diameters first of these measurements should be taken 15° off of the parting line.
7. The weight shown on the drawing is based on the design weight of the preform. The actual weight will vary based on the actual production weight of the preforms.
8. The fill levels are based upon water at room temperature. Alcohol fill levels may vary.
9. Dimensions marked with a "*" represent quality gauge pts. and "#" represent manufacturing gauge pts.
10. M53-SP400 Neck Finish -- 1-Turn of Thread -- 6 T.P.I.
11. Minium Side Wall Thickness: 0.30mm (0.012")

CONFIDENTIAL

Capacity Specification			
Overflow Capacity		663.7 ± 13.0 cc	
Volume & Weight Information			
Calculated Overflow Capacity: 663.7		Calculated Fill Line Capacity: mL	
Total Mat'l Vol.: 41.2 cc	Material: PET		Container Target Weight: 56.0 ±2.0 gm
Calculated Surface Area: 413.3 sq.cm	As Blown Density: 1.359 gm/cc		Avg. Wall Thickness: .037" / .94 mm
Drawing Information			
	WEST		Reference Drawing: 49223
Date: 08JUN11	Drawn By: NDH		Customer: STOCK
Title: 625cc ROUND WIDE MOUTH PACKER			
Drawing Type: PRODUCT DRAWING		Amcor Pharmaceutical Packaging USA, Inc 625 Sharp Street	
Drawing Number: C 28214		Rev. F	