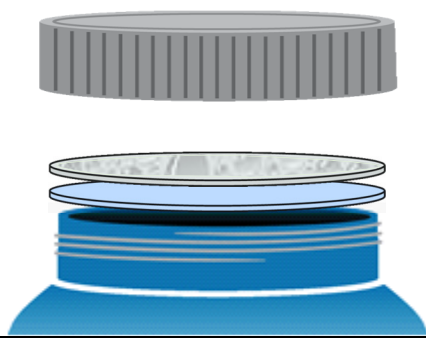

PRODUCT DATA SHEET

PressureSeal 20

- PressureSeal 20 is an inner seal with a construction of polystyrene foam coated with pressure sensitive adhesive.
- The US FDA does not consider liners applied with pressure sensitive adhesive to be an effective tamper-resistant feature.
- Recommended for use with dry products.
- Available with standard or custom print.

Typical Product Attributes

Construction			
Polystyrene Foam Pressure Sensitive Adhesive		SI (µm)	US (Mils)
Thickness Tolerance Minimum Width Width Tolerance		508,0 50,8 – 76,2 ± 10% 25,4 mm ± 1,6 mm	20.0 2.0 – 3.0 ± 10% 1.0 in ± 0.0625 in
Properties			
Oxygen Transmission (O ₂ TR)	Not Tested		
Water Vapor Transmission (WVTR)	Not Tested		
Regulatory Compliance			
FDA Compliance	21 CFR 177.1640 Polystyrene and rubber-modified polystyrene. 21 CFR 177.1210 Closures with sealing gaskets for food containers. 21 CFR 175.125 Pressure-sensitive adhesives.		
Drug Master File (DMF)	002518		
Other Compliances	USFDA Food Allergen Guidelines California Proposition 65 Labeling Requirements Limitations of Heavy Metals in Packaging per CONEG & EU 94/62/EC, Article 11		
Safety Data Sheet (SDS) Statement	Safety Data Sheets (SDS) are not required for articles as defined in 29 CFR 1910.1200, the OSHA Hazard Communication Standard (HazCom). This product is an article as defined by HazCom and is not considered to be, or to contain, a hazardous chemical based on evaluations made by our company.		
Please note that construction does not reflect adhesive or resin bonding layers, if present.			

Revision Number: 4
Revised Date: 2018-06-08

DISCLAIMER: This information is believed to be accurate at the time of printing and is subject to change without notice. Providing this information does not convey any licenses under any patent rights or intellectual property rights of Tri-Seal or others. TRI-SEAL MAKES NO WARRANTY, EXPRESS OR IMPLIED, WITH RESPECT TO THIS INFORMATION AND DISCLAIMS ALL LIABILITY FROM RELIANCE ON IT. Tri-Seal's only warranties for this product are those written warranties as may be agreed to by Tri-Seal and its customers. TRI-SEAL SPECIFICALLY DISCLAIMS ALL OTHER WARRANTIES, EXPRESS OR IMPLIED, WITH RESPECT TO THE PRODUCT, INCLUDING, BUT NOT LIMITED TO, WARRANTIES OF MERCHANTABILITY AND FITNESS FOR PARTICULAR PURPOSE.

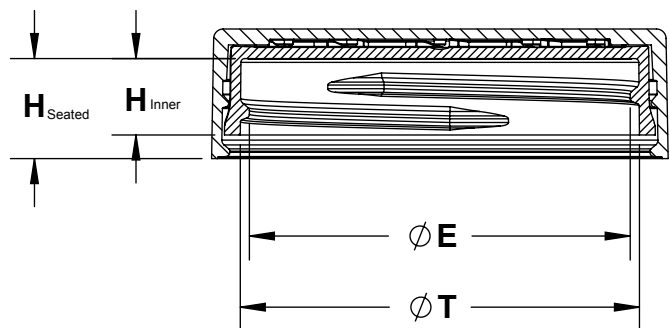
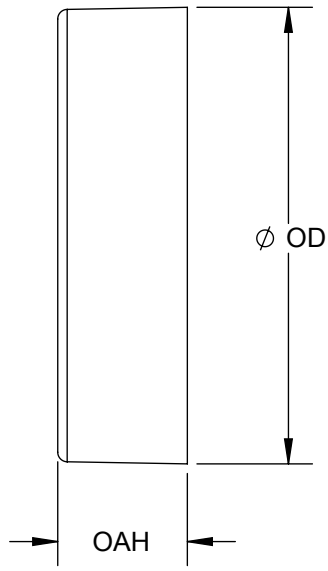
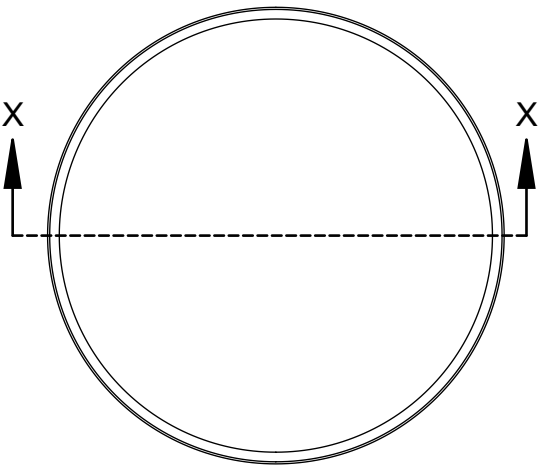

SECTION X-X
SCALE 1 : 1

6 THREADS PER INCH, .167 PITCH,
380° FULL DEPTH THREAD

REFERENCE	TOLERANCE	DIMENSION	UNITS
E	±0.012 [0.30]	1.985 [50.42]	in [mm]
T	±0.012 [0.30]	2.079 [52.81]	in [mm]
H [Seated]	REFERENCE	0.521 [13.23]	in [mm]
H [INNER]	±0.012 [0.30]	0.398 [10.11]	in [mm]
OD	±0.018 [0.46]	2.388 [60.66]	in [mm]
OAH	±0.020 [0.51]	0.675 [17.15]	in [mm]
PART WEIGHT	± 1.4	12.8	g

STATIC TORQUE RECOMMENDATION
21-36 in-lbs
THIS REQUIREMENT MAY VARY DEPENDING
UPON BOTTLE MATERIAL, NECK FINISH, AND
CAPPING EQUIPMENT

THE CLOSURE DIMENSIONS
DEPICTED ARE THOSE WHICH HAVE GENERALLY BEEN
FOUND TO BE FUNCTIONAL BASED ON INDUSTRY
EXPERIENCE BECAUSE OF VARIABILITY IN GLASS AND
PLASTIC CONTAINER FINISHES, EACH CLOSURE/FINISH
SYSTEM SHOULD BE INDIVIDUALLY EVALUATED AND
TESTED TO ENSURE IT MEETS APPLICABLE
PERFORMANCE CRITERIA. SEE QUALITY ASSURANCE
SPECIFICATIONS FOR ADDITIONAL INFORMATION.

MOLD-RITE, WEATHERCHEM AND STULL TECHNOLOGIES
RESERVES THE RIGHT TO REVISE ANY OR ALL
SPECIFICATIONS AND REQUIREMENTS.

DRAWING TYPE : CUSTOMER

REPLACES DRAWINGS: DIMENSIONS ENCLOSED IN ()
INDICATE REFERENCE DIMENSIONS AND NO TOLERANCE
LIMITS ARE ESTABLISHED

TOLERANCES UNLESS OTHERWISE SPECIFIED			
DIMENSION (inches)	TOLERANCE	DIMENSION (mm)	TOLERANCE
0-0.787	±0.006	0-20	±0.152
0.788-1.181	±0.008	21-30	±0.203
1.182-2.756	±0.012	31-70	±0.305
2.757-3.937	±0.016	71-100	±0.406
3.938-5.096	±0.020	101-150	±0.508
5.097-7.874	±0.024	151-200	±0.610
7.875-9.843	±0.032	201-250	±0.813

ANGULAR TOLERANCE ± 2°
PROPRIETARY AND CONFIDENTIAL

THIS DRAWING IS PROTECTED BY COPYRIGHT AND CONTAINS INFORMATION
PROPRIETARY TO MOLD-RITE, WEATHERCHEM AND STULL TECHNOLOGIES.
ANY REPRODUCTION, DISCLOSURE, OR USE OF ITS CONTENTS OR ANY PART
THEREOF IS EXPRESSLY PROHIBITED EXCEPT AS MOLD-RITE, WEATHERCHEM
AND STULL TECHNOLOGIES OTHERWISE MAY AGREE IN WRITING



THIRD ANGLE PROJECTION 	DISTRIBUTION CODE D	DRAWING NAME 53-400 CRC Assm SMOOTH SIDE/SMOOTH TOP	
		DRAWING NUMBER CQA - 11179	
DRAWN BY: BDG	9/19/2018	MATERIAL POLYPROPYLENE	
ENG APPR: CAN	11/11/2019	MODEL NUMBER: PM 10135 53-400 PDT CRC Assm	
QA APPR: REL	04/12/2019	SCALE 1:2	SHEET SIZE 8.5" X 11"
		SHEET 1 of 3	REV.NP 01.AC

REVISION HISTORY					
DATE	REV	N/P	DESCRIPTION	ENG	DRW
9/19/18	01	AA	DRAWING CREATED	BDG	BDG
3/26/19	01	AB	WEIGHT UPDATED	CAN	CAN
11/11/19	01	AC	ADDED GATE LOCATION NOTE	CAN	CAN

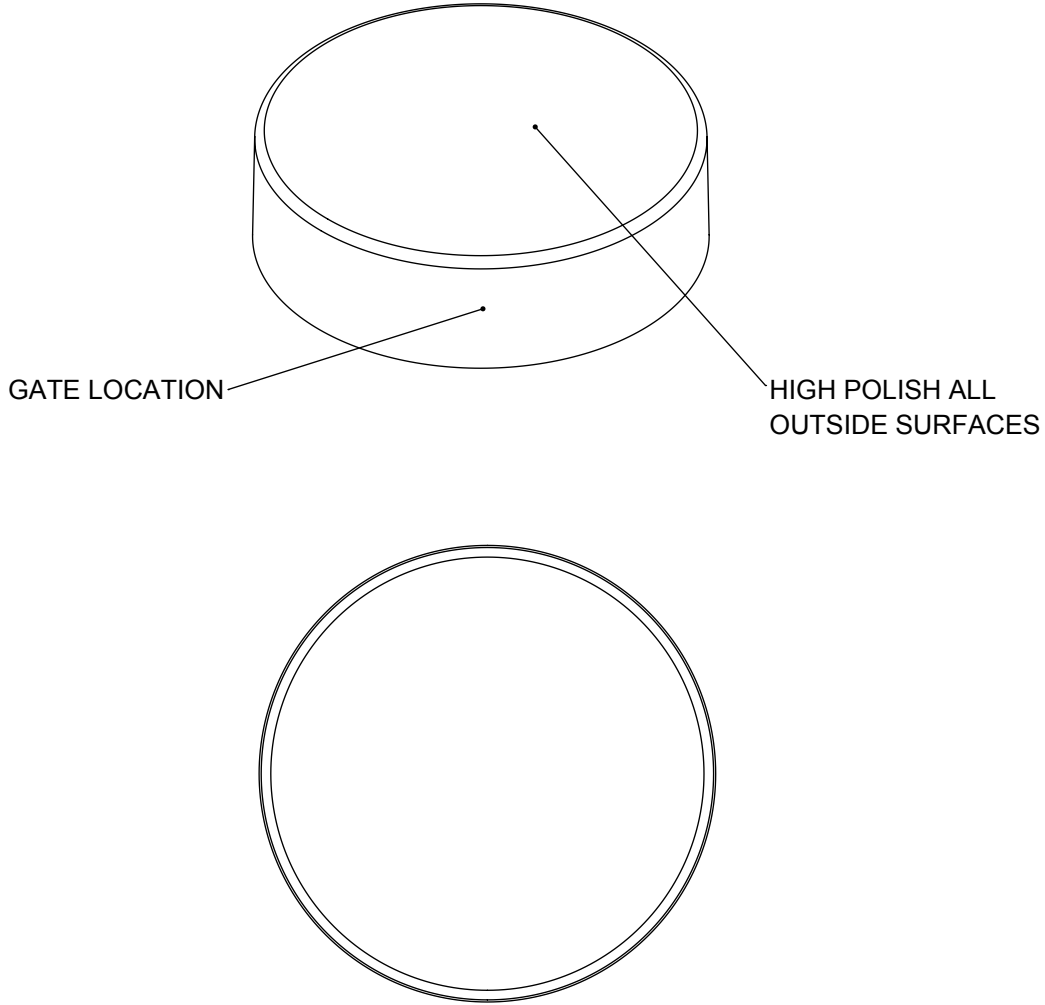

THE CLOSURE DIMENSIONS DEPICTED ARE THOSE WHICH HAVE GENERALLY BEEN FOUND TO BE FUNCTIONAL BASED ON INDUSTRY EXPERIENCE BECAUSE OF VARIABILITY IN GLASS AND PLASTIC CONTAINER FINISHES, EACH CLOSURE/FINISH SYSTEM SHOULD BE INDIVIDUALLY EVALUATED AND TESTED TO ENSURE IT MEETS APPLICABLE PERFORMANCE CRITERIA. SEE QUALITY ASSURANCE SPECIFICATIONS FOR ADDITIONAL INFORMATION.

MOLD-RITE, WEATHERCHEM AND STULL TECHNOLOGIES RESERVES THE RIGHT TO REVISE ANY OR ALL SPECIFICATIONS AND REQUIREMENTS.

DRAWING TYPE : CUSTOMER			
REFERENCES:		DIMENSIONS ENCLOSED IN () INDICATE REFERENCE DIMENSIONS AND NO TOLERANCE LIMITS ARE ESTABLISHED	
TOLERANCES UNLESS OTHERWISE SPECIFIED			
DIMENSION (inches)	TOLERANCE	DIMENSION (mm)	TOLERANCE
0-0.787	±0.006	0-20	±0.152
0.788-1.181	±0.008	21-30	±0.203
1.182-2.756	±0.012	31-70	±0.305
2.757-3.937	±0.016	71-100	±0.406
3.938-5.096	±0.020	101-150	±0.508
5.097-7.874	±0.024	151-200	±0.610
7.875-9.843	±0.032	201-250	±0.813
ANGULAR TOLERANCE ± 2°			
PROPRIETARY AND CONFIDENTIAL			
THIS DRAWING IS PROTECTED BY COPYRIGHT AND CONTAINS INFORMATION PROPRIETARY TO MOLD-RITE, WEATHERCHEM AND STULL TECHNOLOGIES. ANY REPRODUCTION, DISCLOSURE, OR USE OF ITS CONTENTS OR ANY PART THEREOF IS EXPRESSLY PROHIBITED EXCEPT AS MOLD-RITE, WEATHERCHEM AND STULL TECHNOLOGIES OTHERWISE MAY AGREE IN WRITING			

 <small>SOLIDWORKS</small>	D DISTRIBUTION CODE	DRAWING NAME	
		53-400 CRC Assm SMOOTH SIDE/SMOOTH TOP	
		DRAWING NUMBER	
		CQA - 11179	
		MATERIAL	
		POLYPROPYLENE	
		MODEL NUMBER:	
		PM 10135 53-400 PDT CRC Assm	
DRAWN BY:	BDG	9/19/2018	
ENG APPR.:	CAN	11/11/2019	
QA APPR.:	REL	04/12/2019	
SCALE	SHEET SIZE	SHEET	REV.NP
1:2	8.5" X 11"	2 of 3	01.AC

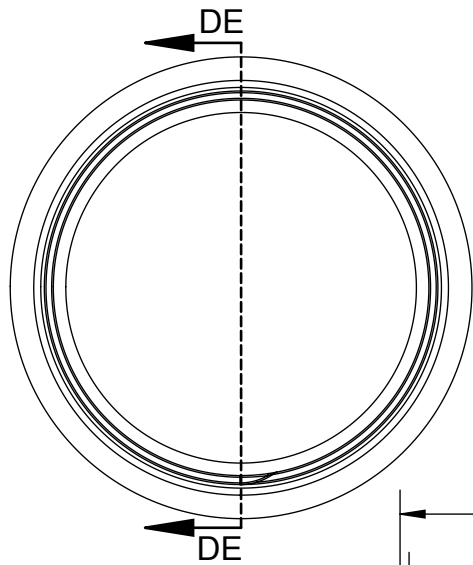

0.050 MINIMUM flat for induction sealing

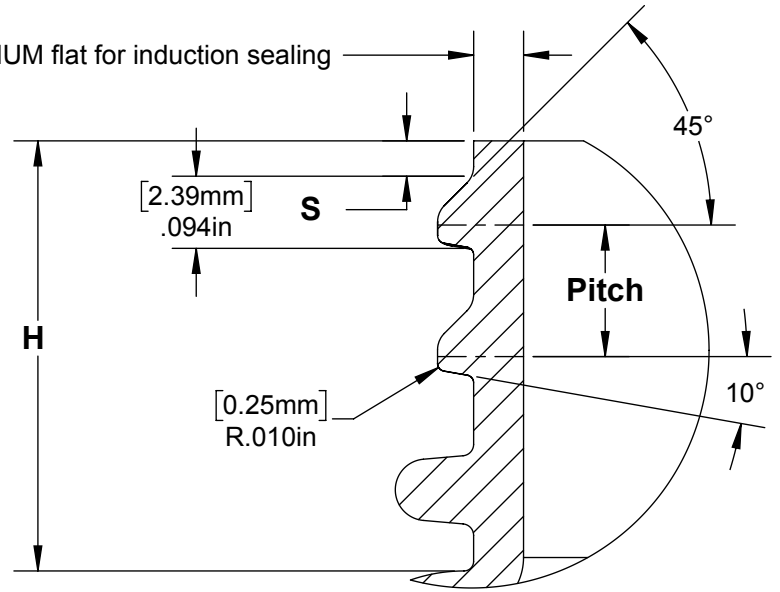

DETAIL Thread
SCALE 4 : 1

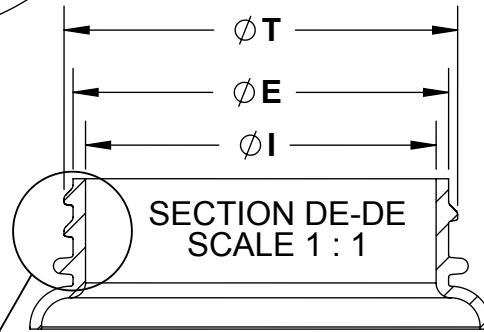

SECTION DE-DE
SCALE 1 : 1

Thread

REFERENCE	TOLERANCE	UNITS	DIMENSION
E	± 0.017 [0.43]	in [mm]	1.956 [49.68]
T	± 0.017 [0.43]	in [mm]	2.050 [52.07]
I	MINIMUM	in [mm]	1.578 [40.08]
S	±0.015[0.38]	in [mm]	0.046 [1.17]
H	MINIMUM	in [mm]	0.560 [14.22]
H1	MINIMUM	in [mm]	0.410 [10.41]
B	MAXIMUM	in [mm]	2.160 [54.86]
TPI			6
PITCH		in [mm]	0.167 [4.24]

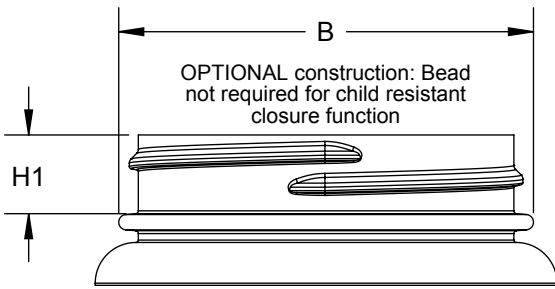

OPTIONAL construction: Bead
not required for child resistant
closure function

NOTE: THE NOMINAL ORIENTATION ILLUSTRATED IS BASED ON NOMINAL DIMENSIONS OF BOTH THE CLOSURE AND THE RECOMMENDED NECK FINISH. FOR EXACT ORIENTATION EACH BOTTLE SHOULD BE EVALUATED ON A CASE BY CASE BASIS.

THE CLOSURE DIMENSIONS DEPICTED ARE THOSE WHICH HAVE GENERALLY BEEN FOUND TO BE FUNCTIONAL BASED ON INDUSTRY EXPERIENCE BECAUSE OF VARIABILITY IN GLASS AND PLASTIC CONTAINER FINISHES, EACH CLOSURE/FINISH SYSTEM SHOULD BE INDIVIDUALLY EVALUATED AND TESTED TO ENSURE IT MEETS APPLICABLE PERFORMANCE CRITERIA. SEE QUALITY ASSURANCE SPECIFICATIONS FOR ADDITIONAL INFORMATION.

MOLD-RITE, WEATHERCHEM AND STULL TECHNOLOGIES RESERVES THE RIGHT TO REVISE ANY OR ALL SPECIFICATIONS AND REQUIREMENTS.

DRAWING TYPE : CUSTOMER

DIMENSIONS ENCLOSED IN () INDICATE REFERENCE DIMENSIONS AND NO TOLERANCE LIMITS ARE ESTABLISHED

TOLERANCES UNLESS OTHERWISE SPECIFIED

DIMENSION (inches)	TOLERANCE	DIMENSION (mm)	TOLERANCE
0-0.787	±0.006	0-20	±0.152
0.788-1.181	±0.008	21-30	±0.203
1.182-2.756	±0.012	31-70	±0.305
2.757-3.937	±0.016	71-100	±0.406
3.938-5.096	±0.020	101-150	±0.508
5.097-7.874	±0.024	151-200	±0.610
7.875-9.843	±0.032	201-250	±0.813

ANGULAR TOLERANCE ± 2°

PROPRIETARY AND CONFIDENTIAL

THIS DRAWING IS PROTECTED BY COPYRIGHT AND CONTAINS INFORMATION PROPRIETARY TO MOLD-RITE, WEATHERCHEM AND STULL TECHNOLOGIES. ANY REPRODUCTION, DISCLOSURE, OR USE OF ITS CONTENTS OR ANY PART THEREOF IS EXPRESSLY PROHIBITED EXCEPT AS MOLD-RITE, WEATHERCHEM AND STULL TECHNOLOGIES OTHERWISE MAY AGREE IN WRITING



SOLIDWORKS

DISTRIBUTION CODE

D

DRAWING NAME

53-400 CRC Assm
RECOMMENDED NECK FINISH

DRAWING NUMBER

CQA - 11179

MATERIAL

MODEL NUMBER:

DRAWN BY:

BDG

9/19/2018

ENG APPR.:

CAN

11/11/2019

QA APPR.:

REL

04/12/2019

SCALE

1:2

SHEET SIZE

8.5" X 11"

SHEET

3 of 3

REV/N/P

01.AC