

SECTION A-A
SCALE 1 : 1



STATIC TORQUE RECOMMENDATION: 21-36 in-lbs
REQUIREMENT MAY VARY DEPENDING UPON CONTAINER MATERIAL,
NECK FINISH, AND CAPPING EQUIPMENT

DIMENSIONS ENCLOSED IN () INDICATE REFERENCE DIMENSIONS
AND NO TOLERANCE LIMITS ARE ESTABLISHED

DIMENSIONS PRECEDED BY AN "" INDICATE THE DIMENSION IS
PROCESS SENSITIVE. PROCESS SENSITIVE DIMENSIONS ARE
VERIFIED TO BE WITHIN THE TOLERANCE LIMITS DURING THE
PRODUCTION RUN. ALL REMAINING DIMENSIONS ARE VERIFIED AT
PRODUCTION VALIDATION.

PROPRIETARY AND CONFIDENTIAL

THIS DRAWING IS PROTECTED BY COPYRIGHT AND CONTAINS
INFORMATION PROPRIETARY TO MOLD-RITE PLASTICS AND ITS
SUBSIDIARIES. ANY REPRODUCTION, DISCLOSURE, OR USE OF
ITS CONTENTS OR ANY PART THEREOF IS EXPRESSLY
PROHIBITED EXCEPT AS MOLD-RITE PLASTICS AND ITS
SUBSIDIARIES OTHERWISE MAY AGREE IN WRITING.

THIS MASTER DOCUMENT IS CONTROLLED ELECTRONICALLY.
PRINTED OR DOWNLOADED COPIES ARE UNCONTROLLED.
DOCUMENT USERS ARE RESPONSIBLE FOR ENSURING THEY HAVE
THE LATEST REVISION PRIOR TO USE.

THE PART DIMENSIONS DEPICTED ARE THOSE WHICH HAVE GENERALLY BEEN FOUND TO BE FUNCTIONAL BASED ON INDUSTRY EXPERIENCE.
BECAUSE OF VARIABILITY IN CONTAINER FINISHES, EACH CLOSURE/FINISH SYSTEM SHOULD BE INDIVIDUALLY EVALUATED AND TESTED TO
ENSURE IT MEETS APPLICABLE PERFORMANCE CRITERIA.

MOLD-RITE PLASTICS AND ITS SUBSIDIARIES RESERVE THE RIGHT TO REVISE ANY OR ALL SPECIFICATIONS AND REQUIREMENTS.

REFERENCE	TOLERANCE	DIMENSION	UNITS
E	±0.012 [0.30]	1.985 [50.42]	in [mm]
T'	±0.012 [0.30]	2.079 [52.81]	in [mm]
H [Seated]	REFERENCE	0.521 [13.23]	in [mm]
H [INNER]	±0.012 [0.30]	0.398 [10.11]	in [mm]
OD	±0.018 [0.46]	2.388 [60.66]	in [mm]
OAH	±0.020 [0.51]	0.675 [17.15]	in [mm]
PART WEIGHT	REFERENCE	12.5	g

THREAD DETAIL INFORMATION: 6 THREADS PER INCH 0.167" [4.24] PITCH 380° FULL DEPTH THREADS

DRAWN BY:	BDG	3/1/2016
ENG APPR:	REL	9/11/2018
QA APPR:	BDG	9/11/2018



DRAWING TITLE:
53-400 CRC Assm
PDT DEBOSS

MATERIAL: POLYPROPYLENE

DRAWING TYPE: CUSTOMER DISTRIBUTION CODE: D

REPLACES DRAWINGS:

MODEL NUMBER: PM 10135 53-400 PDT CRC Assm

DWG SIZE: 8.5" x 11" DRAWING NUMBER: REVISION:

SCALE: SHEET: CQA-10093 02.AD

1:2 & NOTED 1 OF 3

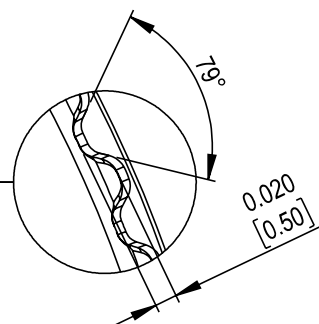
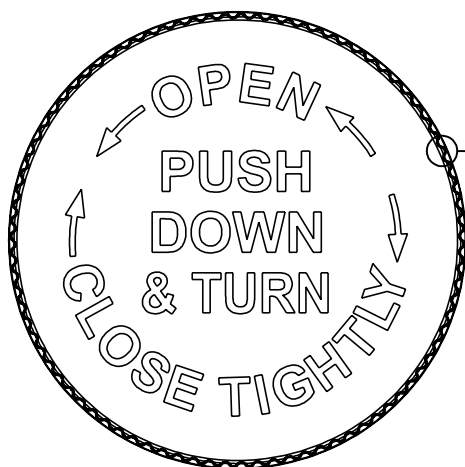

DETAIL RIBBING
SCALE 6 : 1
(88) EQUISPACED RIBS

DIMENSIONS ENCLOSED IN () INDICATE
REFERENCE DIMENSIONS AND NO
TOLERANCE LIMITS ARE ESTABLISHED

PROPRIETARY AND CONFIDENTIAL
THIS DRAWING IS PROTECTED BY
COPYRIGHT AND CONTAINS INFORMATION
PROPRIETARY TO MOLD-RITE PLASTICS
AND ITS SUBSIDIARIES, ANY
REPRODUCTION, DISCLOSURE, OR USE
OF ITS CONTENTS OR ANY PART
THEREOF IS EXPRESSLY PROHIBITED
EXCEPT AS MOLD-RITE PLASTICS AND ITS
SUBSIDIARIES OTHERWISE MAY AGREE IN
WRITING

THE PART DIMENSIONS DEPICTED ARE
THOSE WHICH HAVE GENERALLY BEEN
FOUND TO BE FUNCTIONAL BASED ON
INDUSTRY EXPERIENCE
BECAUSE OF VARIABILITY IN CONTAINER
FINISHES, EACH CLOSURE/FINISH
SYSTEM SHOULD BE INDIVIDUALLY
EVALUATED AND TESTED TO
ENSURE IT MEETS APPLICABLE
PERFORMANCE CRITERIA.
MOLD-RITE PLASTICS AND ITS
SUBSIDIARIES RESERVE THE RIGHT TO
REVISE ANY OR ALL SPECIFICATIONS
AND REQUIREMENTS.

REVISION HISTORY

DATE	REV	N/P	DESCRIPTION	ENG	DRW
03/11/15	01	AA	DRAWING CREATED	BDG	BDG
09/29/15	01	AB	UPDATED SPECIFICATIONS BASED ON PRODUCTION VALIDATION	BDG	BDG
02/10/16	02	AA	UPDATED ASSEMBLY MODEL WITH REVISED INNER, CRC ENGINE ANGLE REVISED	BDG	BDG
07/07/16	02	AB	UPDATED SPECIFICATION BASED ON REQUALIFICATION OF MOLDS	BDG	BDG
09/11/18	02	AC	UPDATED DRAWING FORMAT. CORRECTED (mm) CONVERSION FOR PAGE 3	BDG	BDG
06/20/23	02	AD	UPDATED DRAWING STANDARD AND LOGO	BDG	BDG

REVISION HISTORY

REVISIONS: REV: A PHYSICAL CHANGE TO THE PART IMPACTING FIT, FORM OR FUNCTION
N/P: DRAWING OR SPECIFICATION CHANGE ONLY



DRAWING TITLE:
53-400 CRC Assm
PDT DEBOSS

THIS MASTER DOCUMENT IS CONTROLLED ELECTRONICALLY.
PRINTED OR DOWNLOADED COPIES ARE UNCONTROLLED.
DOCUMENT USERS ARE RESPONSIBLE FOR ENSURING THEY
HAVE THE LATEST REVISION PRIOR TO USE.

DRAWING TYPE: CUSTOMER		DISTRIBUTION CODE: D	
DWG SIZE: 8.5" x 11"	DRAWING NUMBER: CQA-10093	REVISION: 02.AD	
SCALE: 1:2 & NOTED	SHEET: 2 OF 3		

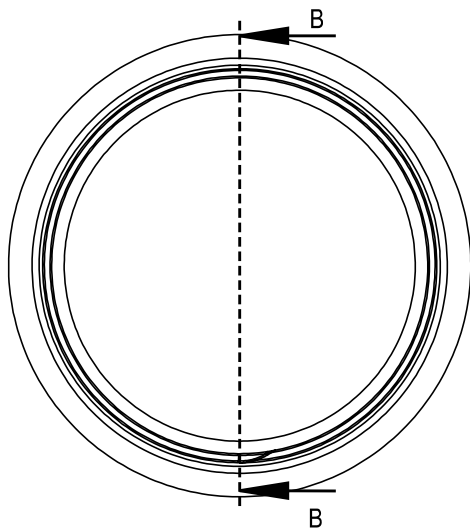

0.050 MINIMUM flat for induction sealing

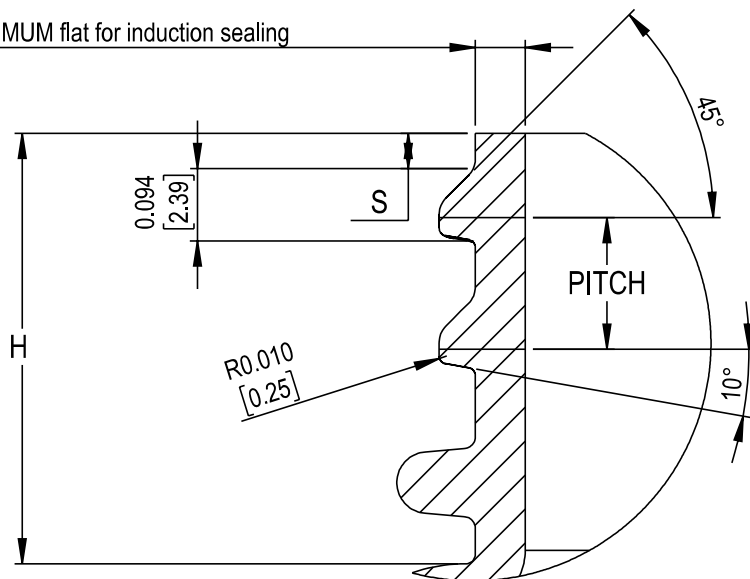

DETAIL Thread
SCALE 4 : 1

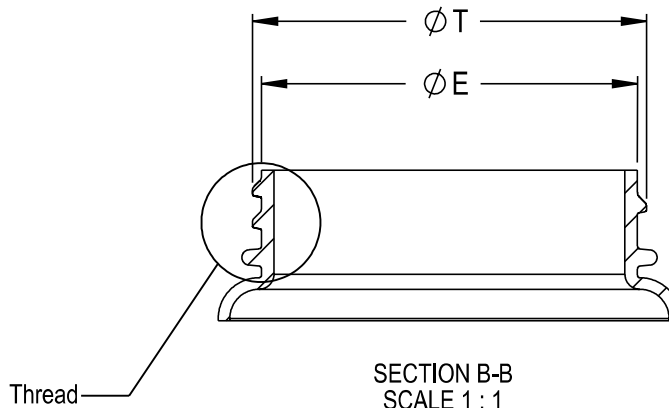
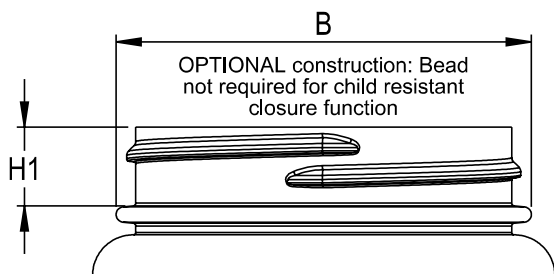

SECTION B-B
SCALE 1 : 1

CHILD RESISTANT PROTOCOL TESTING NOTE: MOLD-RITE PLASTICS, LLC CERTIFIES THAT ITS CHILD RESISTANT CLOSURES PASSED TESTS OUTLINED IN 16 CFR SECTION 1700.20 TESTING PROCEDURE AND MEET WITH REQUIREMENTS DEFINED BY 16 CFR SECTION 1700.15 POISON PREVENTION PACKAGING STANDARDS, GENERALLY. IT IS RECOMMENDED THAT CUSTOMERS CONDUCT TESTING TO CONFIRM CLOSURES PERFORM AS EXPECTED WITH THEIR SPECIFIC CONTAINERS AND CONDITIONS OF USE.

RECOMMENDED NECK FINISH IS DETERMINED FOR PROPER FUNCTIONAL PERFORMANCE WITH MOLD-RITE CLOSURE. USE OF MOLD-RITE CLOSURE WITH CONTAINER NOT MATCHING RECOMMENDED NECK FINISH SHOULD BE TESTED AND CONFIRMED FOR APPLICATION BY THE USER.

NOMINAL ORIENTATION OF CLOSURE (IF INDICATED) IS BASED ON NOMINAL DIMENSIONS OF BOTH CLOSURE AND RECOMMENDED NECK FINISH. FOR EXACT ORIENTATION, EACH CONTAINER SHOULD BE EVALUATED ON A CASE BY CASE BASIS.

DIMENSIONS ENCLOSED IN () INDICATE REFERENCE DIMENSIONS AND NO TOLERANCE LIMITS ARE ESTABLISHED

PROPRIETARY AND CONFIDENTIAL

THIS DRAWING IS PROTECTED BY COPYRIGHT AND CONTAINS INFORMATION PROPRIETARY TO MOLD-RITE PLASTICS AND ITS SUBSIDIARIES. ANY REPRODUCTION, DISCLOSURE, OR USE OF ITS CONTENTS OR ANY PART THEREOF IS EXPRESSLY PROHIBITED EXCEPT AS MOLD-RITE PLASTICS AND ITS SUBSIDIARIES OTHERWISE MAY AGREE IN WRITING

THE PART DIMENSIONS DEPICTED ARE THOSE WHICH HAVE GENERALLY BEEN FOUND TO BE FUNCTIONAL BASED ON INDUSTRY EXPERIENCE. BECAUSE OF VARIABILITY IN CONTAINER FINISHES, EACH CLOSURE/FINISH SYSTEM SHOULD BE INDIVIDUALLY EVALUATED AND TESTED TO ENSURE IT MEETS APPLICABLE PERFORMANCE CRITERIA.

MOLD-RITE PLASTICS AND ITS SUBSIDIARIES RESERVE THE RIGHT TO REVISE ANY OR ALL SPECIFICATIONS AND REQUIREMENTS.

REFERENCE	DIMENSION	TOLERANCE	UNITS
E	1.956 [49.68]	± 0.017 [0.43]	in [mm]
T	2.050 [52.07]	± 0.017 [0.43]	in [mm]
S	0.046 [1.17]	± 0.015 [0.38]	in [mm]
H	0.560 [14.22]	MINIMUM	in [mm]
H1	0.410 [10.41]	MINIMUM	in [mm]
B	2.160 [54.86]	MAXIMUM	in [mm]
TPI	6		
PITCH	0.167 [4.24]		in [mm]



DRAWING TITLE:
53-400 CRC Assm
PDT DEBOSS
RECOMMENDED NECK FINISH

THIS MASTER DOCUMENT IS CONTROLLED ELECTRONICALLY. PRINTED OR DOWNLOADED COPIES ARE UNCONTROLLED. DOCUMENT USERS ARE RESPONSIBLE FOR ENSURING THEY HAVE THE LATEST REVISION PRIOR TO USE.

DRAWING TYPE: CUSTOMER DISTRIBUTION CODE: D

DWG SIZE: 8.5" x 11" DRAWING NUMBER: REVISION:

SCALE: 1:2 & NOTED SHEET: 3 OF 3 CQA-10093 02.AD