

REVISIONS					
DATE	REV.	DESCRIPTION	AUTHOR	DRAWN BY	APPROVED
7/21/20	A	UPDATED TO INCLUDE REVISION HISTORY	BK	SL	BK

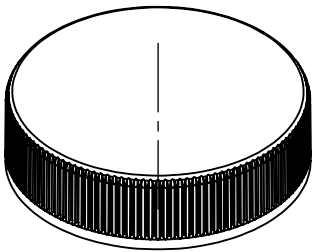

ISOMETRIC VIEW
ACTUAL SIZE



ORANGE PRODUCTS, Inc.

**1929 Vultee St,
Allentown, PA, 18103**
www.orangeproducts.com

Part name:
38 mm CT CLOSURE RIBBED

Project name:
38 mm CT CLOSURE

Material:
POLYPROPYLENE

Weight:
3.04 ±.3 gr

Designed by:
S. Loukov

Approved by:
Bruce Klotz

Scale	Size	Drawing number	Rev.	Date
2:1	B	16342PD-38mm	A	7/21/2020

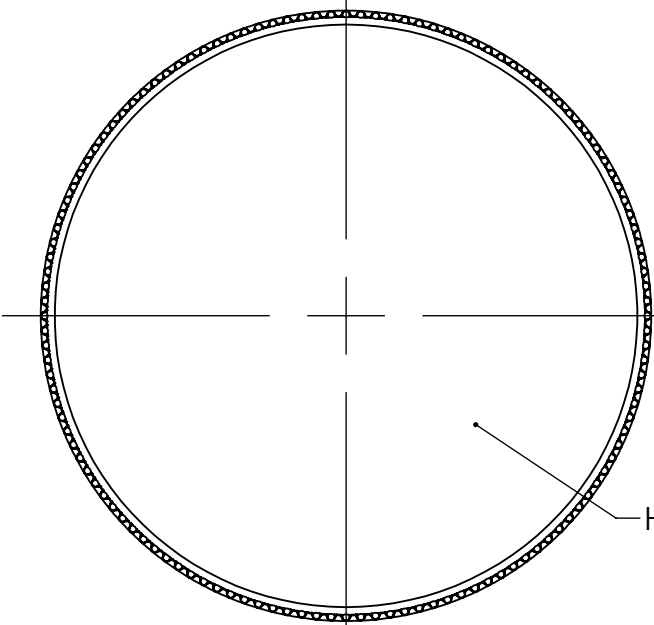

HIGH POLISH

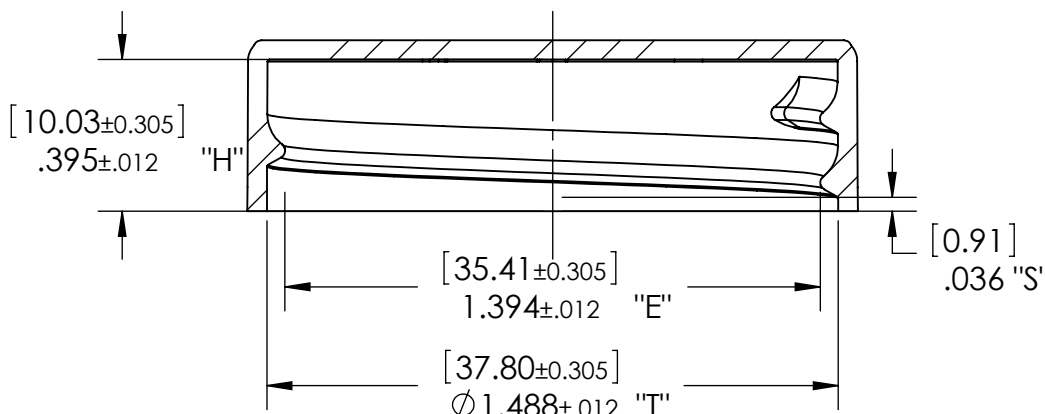
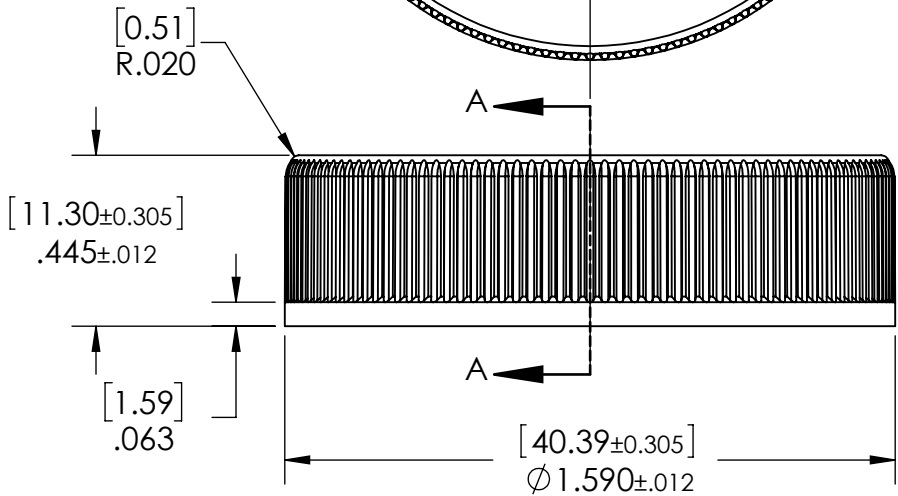

SECTION A-A

THREAD SPECIFICATIONS:
6 THREADS PER INCH, .1667" PITCH
FUUL DEPTH THREAD AT 380°

CONFIDENTIAL PROPERTY
The reproduction, use, or disclosure, in whole or in part, of the design,
or details contained herein is prohibited without prior
written consent of Orange Products, Inc.

All dimensions in inches. General tolerances according to DIN 16901.



INF
Issued for Information



IFA
Issued for Approval



IFC
Issued for Construction



IFP
Issued for Production

CAVITY ID. NUMBER → 27
ORANGE PRODUCT'S LOGO → OPI
CLOSURE SIZE → 38\400